

# U.M.B.A. Storage Room Layout

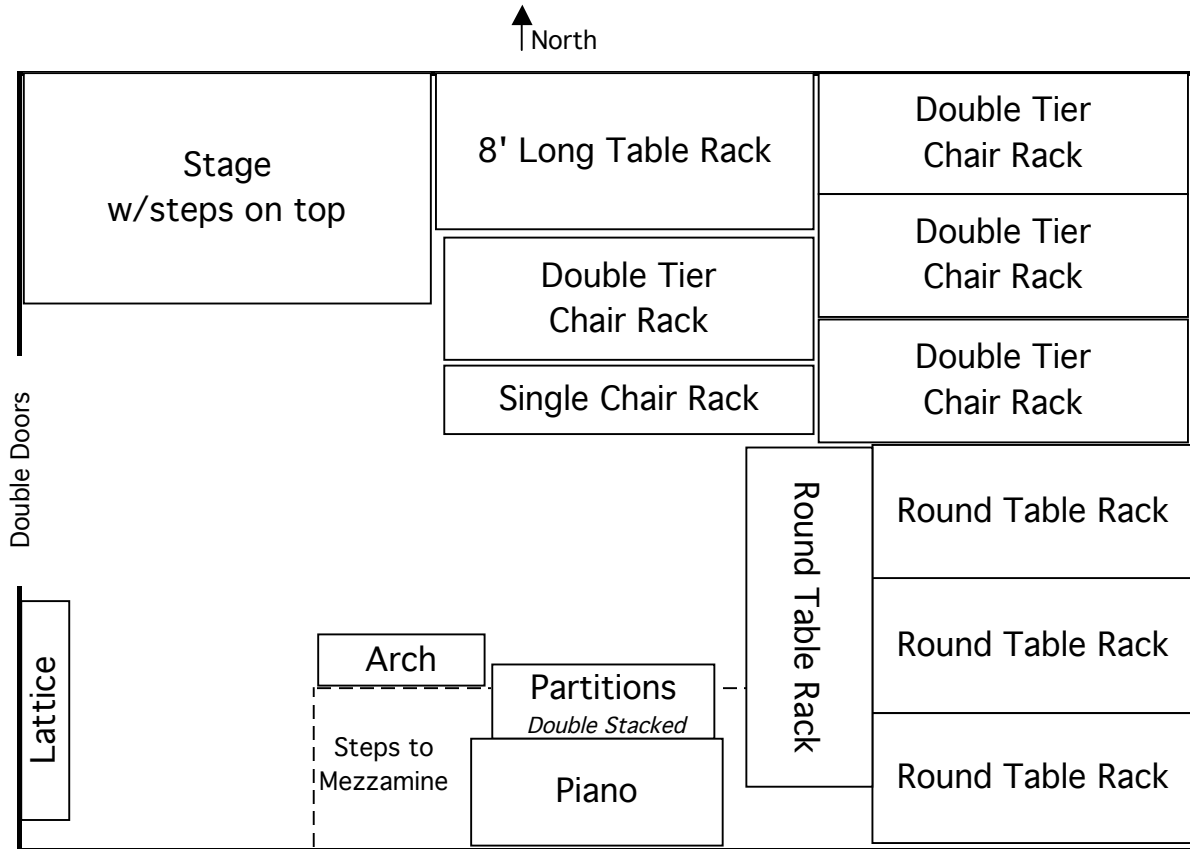

**Double Tier Chair Racks:**

- Place only 4 chairs on the lower tier corners so wheels will pivot.
- 5 chairs on rest.
- Face all chairs in.

**Single Chair Racks:**

- Face all chairs same direction
- Need one person holding stacked chairs upright while others load.

**Round Table Racks:**

- 7 tables per rack
- Face all same direction.
- Need one person holding stacked tables upright while others load.